

2026 Property Record Card



Parcel: **34-20-30-516-0413-0080**
 Property Address: **413 SHEOAH BLVD # 8 WINTER SPRINGS, FL 32708**
 Owners: **CALLAHAN, RICHARD**
 2026 Market Value \$162,396 Assessed Value \$135,006 Taxable Value \$135,006
 2025 Tax Bill \$2,222.35 Tax Savings with Non-Hx Cap \$490.83
 The 2 Bed/2 Bath Condominium property is 1,080 SF and a lot size of 0.01 Acres

Parcel Location



Current Site Picture

Parcel Information

Parcel	34-20-30-516-0413-0080
Property Address	413 SHEOAH BLVD # 8 WINTER SPRINGS, FL 32708
Mailing Address	19 LINCREST ST SYOSSET, NY 11791-6823
Subdivision	SHEOAH SEC 3
Tax District	W1:Winter Springs
DOR Use Code	04:Condominium
Exemptions	None
AG Classification	No

Value Summary

	2026 Working Values	2025 Certified Values
Valuation Method	Cost/Market	Cost/Market
Number of Buildings	1	1
Depreciated Building Value	\$162,396	\$167,601
Depreciated Other Features	\$0	\$0
Land Value (Market)	\$0	\$0
Land Value Agriculture	\$0	\$0
Just/Market Value	\$162,396	\$167,601
Portability Adjustment	\$0	\$0
Save Our Homes Adjustment/Maximum Portability	\$0	\$0
Non-Hx 10% Cap (AMD 1)	\$27,390	\$44,868
P&G Adjustment	\$0	\$0
Assessed Value	\$135,006	\$122,733

2025 Certified Tax Summary

Tax Amount w/o Exemptions	\$2,713.18
Tax Bill Amount	\$2,222.35
Tax Savings with Exemptions	\$490.83

Owner(s)

Name - Ownership Type
 CALLAHAN, RICHARD

Note: Does NOT INCLUDE Non Ad Valorem Assessments

Legal Description

UNIT 8 BLDG 413
SHEOAH SEC 3
PB 18 PGS 38 TO 40

Taxes

Taxing Authority	Assessed	Exempt Amount	Taxable
COUNTY GENERAL FUND	\$135,006	\$0	\$135,006
SCHOOLS	\$162,396	\$0	\$162,396
CITY WINTER SPRINGS	\$135,006	\$0	\$135,006
FIRE	\$135,006	\$0	\$135,006
WATER MANAGEMENT DISTRICT	\$135,006	\$0	\$135,006

Sales

Deed Type	Date	Sale Amount	Book / Page	Sale Type	Qualified?
SPECIAL WARRANTY DEED	4/1/2014	\$45,100	08252/0416	Improved	No
CERTIFICATE OF TITLE	1/1/2014	\$100	08202/0121	Improved	No
CORRECTIVE DEED	4/1/2003	\$100	04790/1396	Improved	No
QUIT CLAIM DEED	1/1/2003	\$100	04663/1131	Improved	No
WARRANTY DEED	12/1/1987	\$35,000	01919/1465	Improved	No
CERTIFICATE OF TITLE	6/1/1987	\$42,400	01863/1801	Improved	No
WARRANTY DEED	6/1/1983	\$43,000	01465/1477	Improved	Yes
WARRANTY DEED	1/1/1977	\$20,000	01142/1538	Improved	Yes
WARRANTY DEED	1/1/1976	\$22,000	01093/1783	Improved	Yes

Land

Units	Rate	Assessed	Market
1 Lot	\$0.10/Lot		

Building Information	
#	1
Use	CONDOS
Year Built*	1973
Bed	2
Bath	2.0
Fixtures	6
Base Area (ft ²)	936
Total Area (ft ²)	1160
Constuction	SIDING GRADE 3
Replacement Cost	\$162,396
Assessed	\$162,396

* Year Built = Actual / Effective

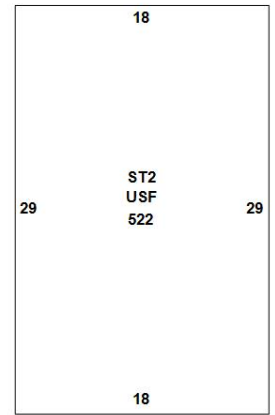
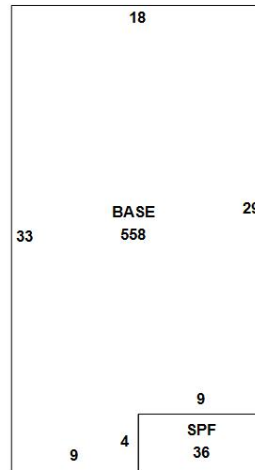

Building 1

Appendages	
Description	Area (ft ²)
ENCLOSED PORCH FINISHED	144
OPEN PORCH FINISHED	64
UTILITY FINISHED	16

Permits				
Permit #	Description	Value	CO Date	Permit Date

Extra Features					
Description	Year Built	Units	Cost	Assessed	

Zoning	
Zoning	PUD
Description	
Future Land Use	High Density Residential
Description	

School Districts	
Elementary	Highlands
Middle	South Seminole
High	Winter Springs

Political Representation	
Commissioner	District 2 - Jay Zembower
US Congress	District 7 - Cory Mills
State House	District 36 - Rachel Plakon
State Senate	District 10 - Jason Brodeur
Voting Precinct	Precinct 28

Utilities	
Fire Station #	Station: 24 Zone: 245
Power Company	DUKE
Phone (Analog)	AT&T
Water	Winter Springs
Sewage	City Of Winter Springs
Garbage Pickup	
Recycle	
Yard Waste	
Hauler #	

Property Value History

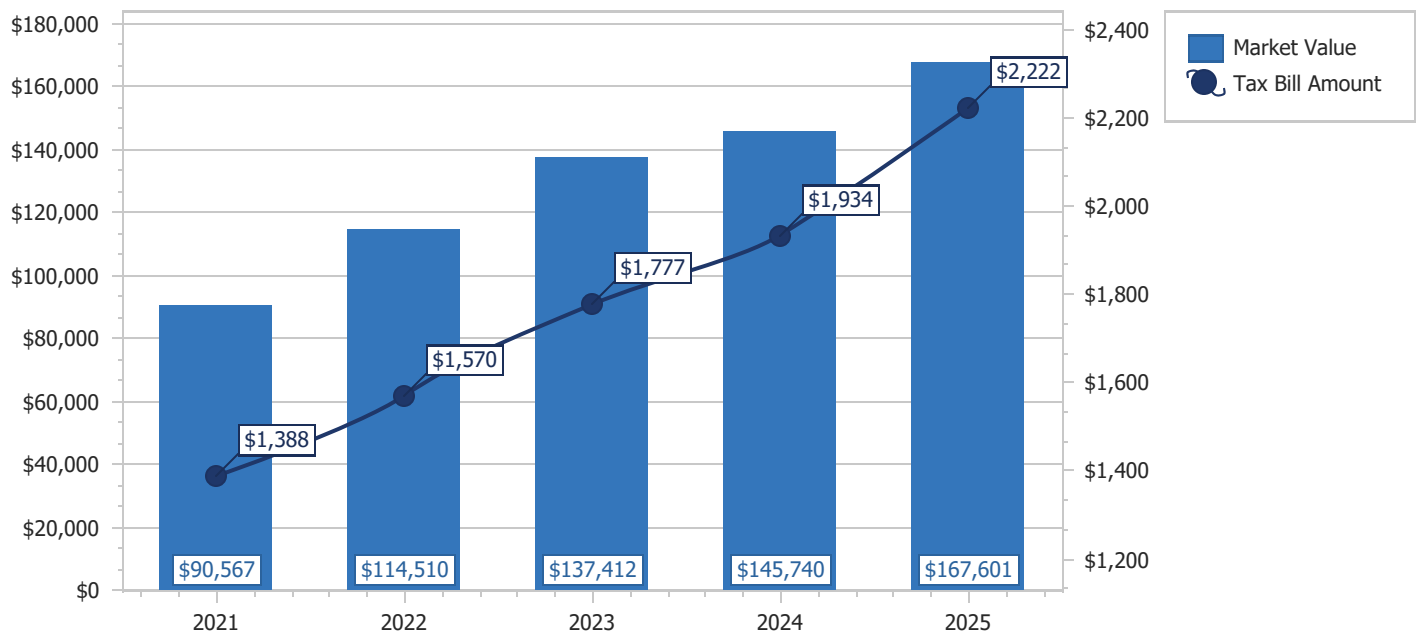

Copyright 2026 © Seminole County Property Appraiser